

Overview

The U-shaped anchor shackle is a general-purpose fitting on the line. Its production is made of hot-dip galvanized round steel. It has a wide range of uses. It can be used alone or in two strings. It is often used for the connection of overhead power lines and substations to insulator strings or steel strands to fix poles and towers. Pins, eyelets and bolts are used for connection.

The U-shaped anchor shackle is a U-shaped fitting used on the power supply line.

The U-shaped anchor shackle can be used to change the angle and lengthen the tensile insulator.

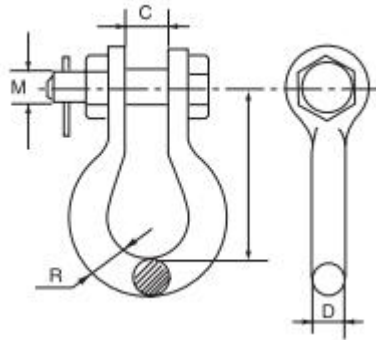

Parameter

Item No.	Main dimensions(mm)					Rated Failure Load(kN)	Weight (kg)
	C	D	M	R	H		
U-7	20	16	16	22	80	70	0.52
U-10	22	18	18	24	85	100	0.73
U-12	24	20	22	30	90	120	1.01
U-16	26	22	24	32	95	160	1.4
U-21	30	24	27	36	100	210	2.12
U-25	34	26	30	40	110	250	3
U-30	38	30	36	46	130	300	4.33
U-50	44	36	42	55	150	500	7